

# 3831 NE Azalea St, Hillsboro, OR

**Main Floor** Total Exterior Area 1459 sq ft  
Total Interior Area 1385 sq ft

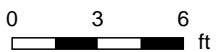

PREPARED: Aug, 2018

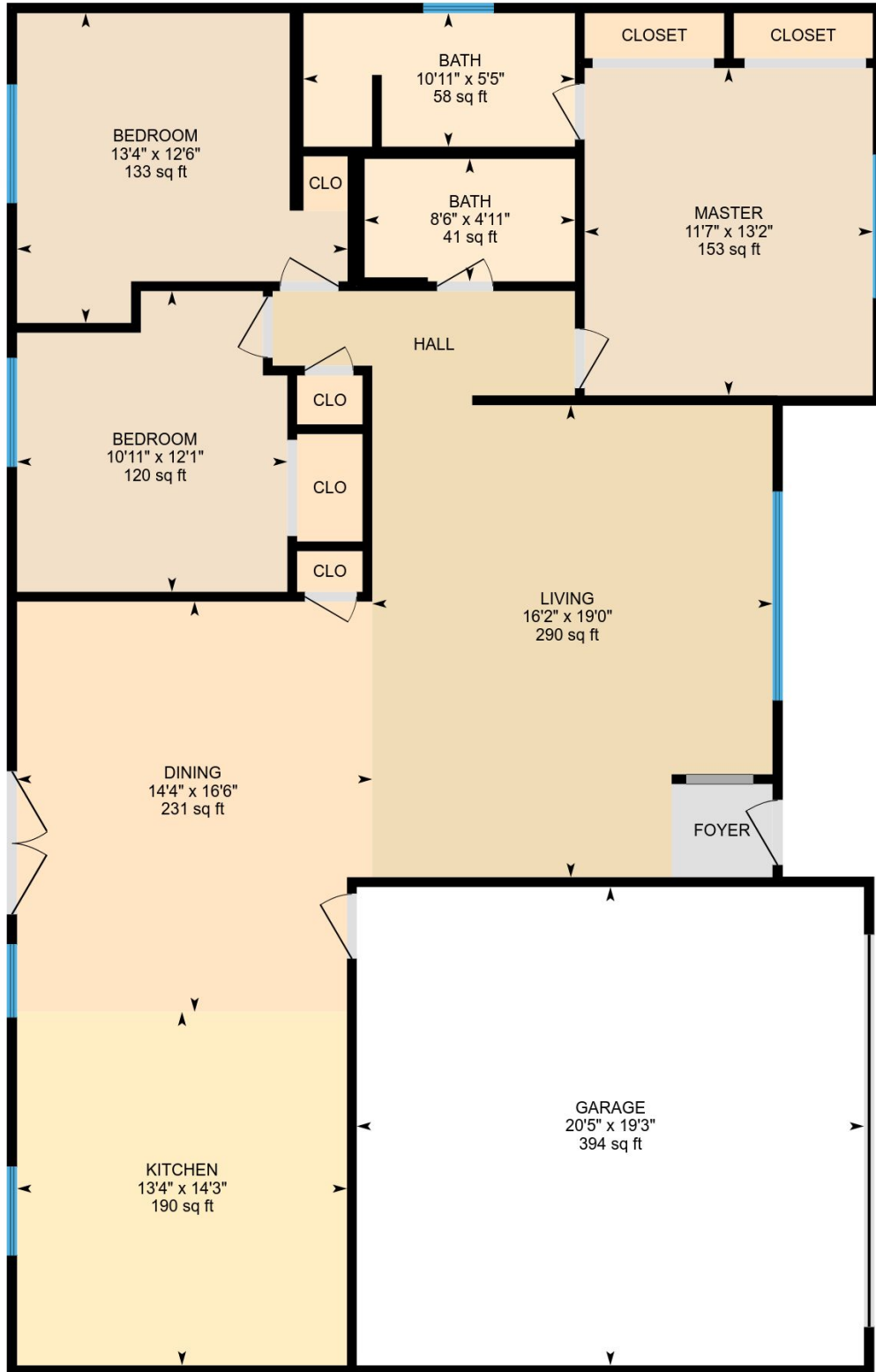

# 3831 NE Azalea St, Hillsboro, OR

---

## Property Details

### Room Measurements

Only major rooms are listed. Some listed rooms may be excluded from total interior floor area (e.g. garage). Room dimensions are largest length and width; parts of room may be smaller. Room area is not always equal to product of length and width.

### Main Building

#### MAIN FLOOR

Bath: 10'11" x 5'5" | 58 sq ft

Bedroom: 13'4" x 12'6" | 133 sq ft

Bath: 8'6" x 4'11" | 41 sq ft

Garage: 20'5" x 19'3" | 394 sq ft

Bedroom: 10'11" x 12'1" | 120 sq ft

Master: 11'7" x 13'2" | 153 sq ft

Living: 16'2" x 19'0" | 290 sq ft

Dining: 14'4" x 16'6" | 231 sq ft

Kitchen: 13'4" x 14'3" | 190 sq ft

### Floor Area Information

For explanation of floor area calculations and method of measurement please see <http://youriguide.com/measure/>

### Main Building

#### MAIN FLOOR

Interior Area: 1385 sq ft

Perimeter Wall Length: 180 ft

Perimeter Wall Thickness: 5 in

Exterior Area: 1459 sq ft

### Total Above Grade Floor Area

Main Building Interior: 1385 sq ft

**Main Building Exterior: 1459 sq ft**