

PROPERTY FLOOR PLAN

File No 12/02/09

Property Address 3255 Macomber Dr.

City Pebble Beach

County Monterey

State CA

Zip 93953

Jamal Noorzoy

Alain Pine Realtors

Junipero, Btwn 5th & 6th, Carmel, CA

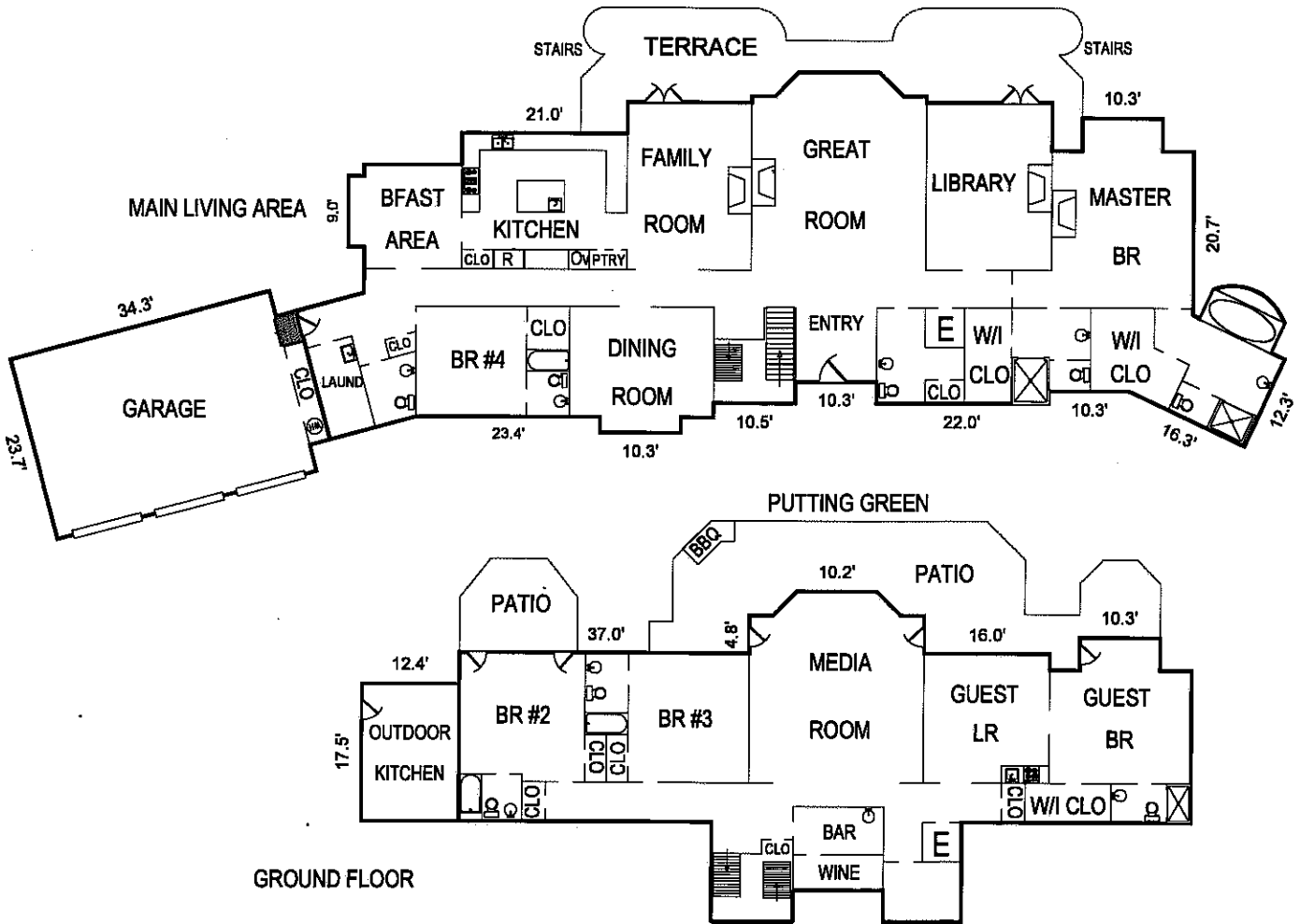

GROUND FLOOR

AREA CALCULATIONS SUMMARY

| Code | Description | Net Size | Net Totals |
|--------------|------------------|----------|--------------|
| GLA1 | Ground Floor | 2424.1 | 2424.1 |
| GLA2 | Main Living Area | 4222.3 | 4222.3 |
| P/P | Patio | 160.0 | |
| | Patio | 736.2 | |
| | Terrace | 675.2 | 1571.4 |
| GAR | Garage | 855.7 | 855.7 |
| OTB | Outdoor Kitchen | 217.3 | 217.3 |
| Total | | | 7,100 |

LIVING AREA BREAKDOWN

| | | | |
|--------------|-----|---|-----|
| Entry: | 13' | x | 10' |
| Kitchen: | 16' | x | 14' |
| Bfast Area: | 12' | x | 12' |
| Dining Room: | 18' | x | 14' |
| Great Room: | 22' | x | 20' |
| Family Room: | 19' | x | 16' |
| Media Room: | 22' | x | 20' |
| Library: | 19' | x | 16' |
| Master BR: | 22' | x | 18' |
| Bedroom #2: | 15' | x | 15' |
| Bedroom #3: | 16' | x | 15' |
| Bedroom #4: | 14' | x | 13' |
| Guest LR: | 16' | x | 15' |
| Guest BR: | 18' | x | 17' |